

- Installation design
- Width 35 mm
- Zoom voltage
- 2 change over contacts



## ► Technical data

### ► 1. Functions

Coupling relay

### ► 2. Indicators

Green LED ON: Indication of supply voltage  
 Yellow LED ON/OFF: Indication of relay output

### ► 3. Mechanical design

Self-extinguishing plastic housing, IP rating IP40  
 Mounted on DIN-Rail TS 35 according to EN 50022  
 Mounting position: any  
 Shockproof terminal connection according to VBG 4 (PZ1 required), IP rating IP20  
 Initial torque: max. 1Nm  
 Terminal capacity:  
 1 x 0.5 to 2.5mm<sup>2</sup> with/without multicore cable end  
 1 x 4mm<sup>2</sup> without multicore cable end  
 2 x 0.5 to 1.5mm<sup>2</sup> with/without multicore cable end  
 2 x 2.5mm<sup>2</sup> flexible without multicore cable end

### ► 4. Input circuit

Supply voltage: 12 to 240V AC/DC terminals A1(+)-A2  
 Tolerance: ±10%  
 Rated frequency: 48 to 63Hz  
 Rated consumption:  
 24V AC/DC 1.5VA (1W)  
 110V AC 4VA (1.5W)  
 230V AC 6VA (2W)  
 Duration of operation: 100%  
 Reset time: –  
 Residual ripple for DC: 10%  
 Drop-out voltage: >30% of supply voltage

### ► 5. Output circuit

2 potential free change over contacts  
 Switching capacity (distance < 5mm): 1250VA (5A / 250V AC)  
 Switching capacity (distance > 5mm): 2000VA (8A / 250V AC)  
 Fusing: 8A fast acting  
 Mechanical life: 20 x 10<sup>6</sup> operations  
 Electrical life: 2 x 10<sup>5</sup> operations  
 at 1000VA resistive load  
 Switching frequency: max. 60/min at 100VA resistive load  
 max. 6/min at 1000VA resistive load  
 (according to IEC 947-5-1)  
 Insulation voltage: 250V AC (according to IEC 664-1)  
 Surge voltage: 4kV, overvoltage category III  
 (according to IEC 664-1)

### ► 6. Ambient conditions

Ambient temperature: -25 to +55°C (according to IEC 68-1)  
 Storage temperature: -25 to +70°C  
 Transport temperature: -25 to +70°C  
 Relative humidity: 15% to 85%  
 (according to IEC 721-3-3 class 3K3)  
 Pollution degree: 2, if built-in 3  
 (according to IEC 664-1))

### ► 7. Dimensions

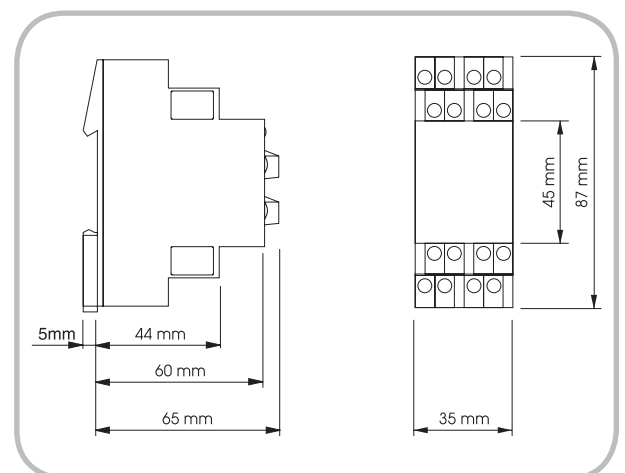

## ► Functions

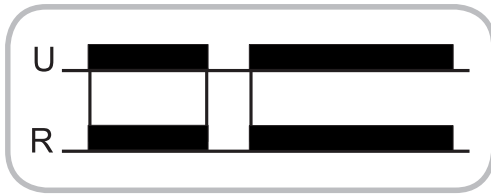

## ► Connections

